

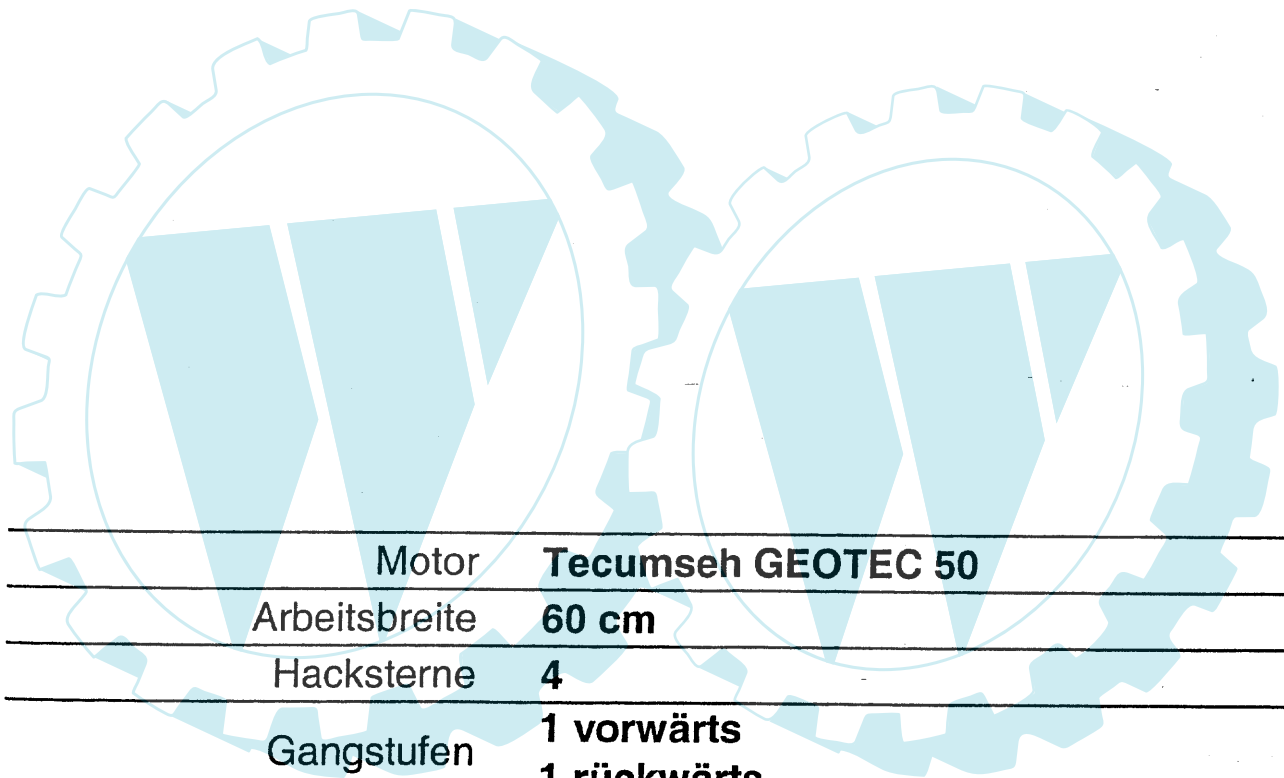

PROGRAMM 2001

HB19NGDP

MOTORHACKE



| | |
|-------------------|-------------------------------------|
| Motor | Tecumseh GEOTEC 50 |
| Arbeitsbreite | 60 cm |
| Hacksterne | 4 |
| Gangstufen | 1 vorwärts 1 rückwärts |
| Getriebekasten | geschweißt |
| Transportrad | ein Rad, vorne, hochklappbar |
| Holm | schwarz |
| GRANJA-Art.-Nr * | 00010351 |
| Hornbach-Art.-Nr. | |
| Hornbach-EAN | |

* erscheint auf dem Herstellerschild auf dem Gerät

Alle Angaben ohne Vertragswert

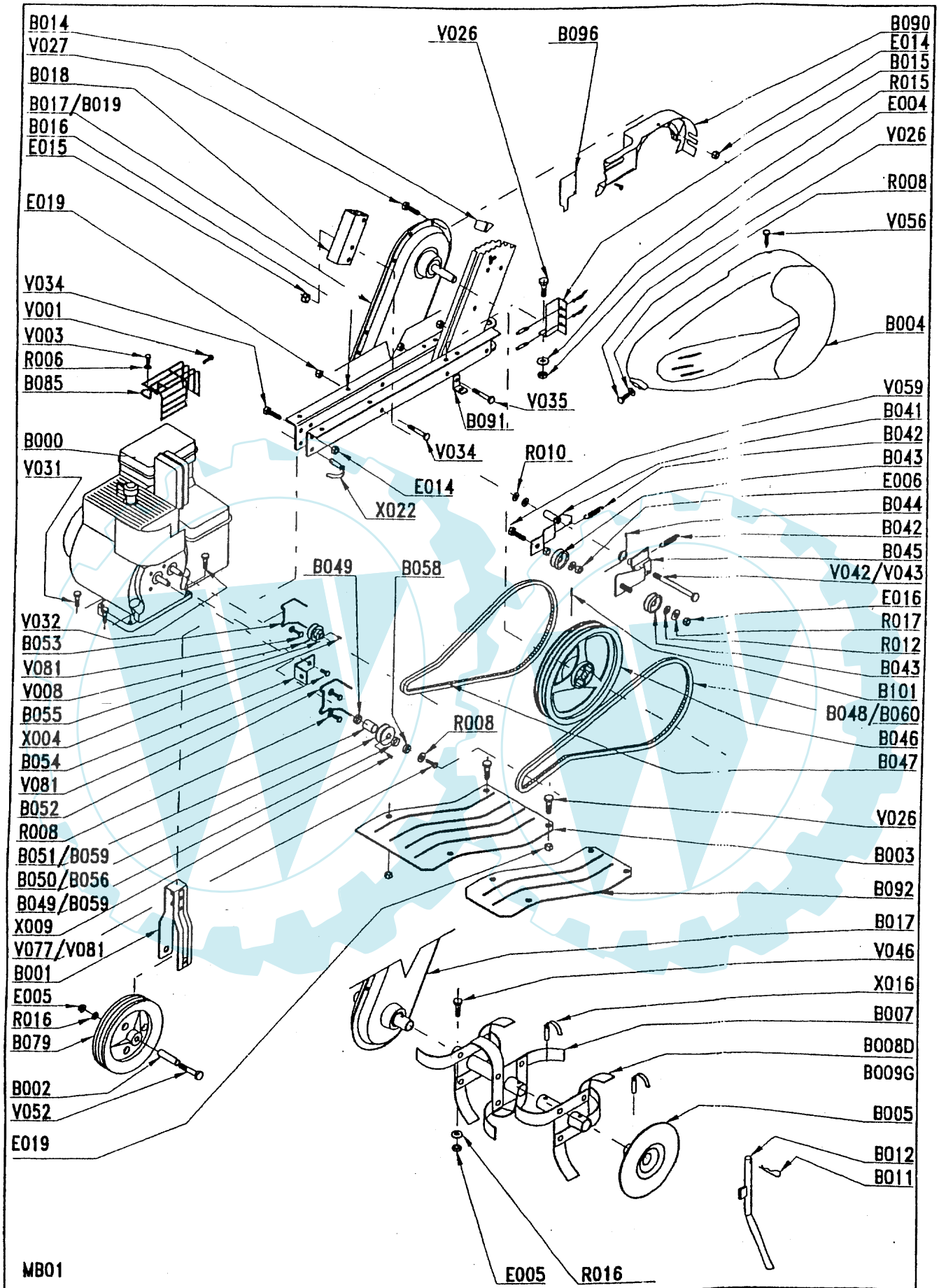

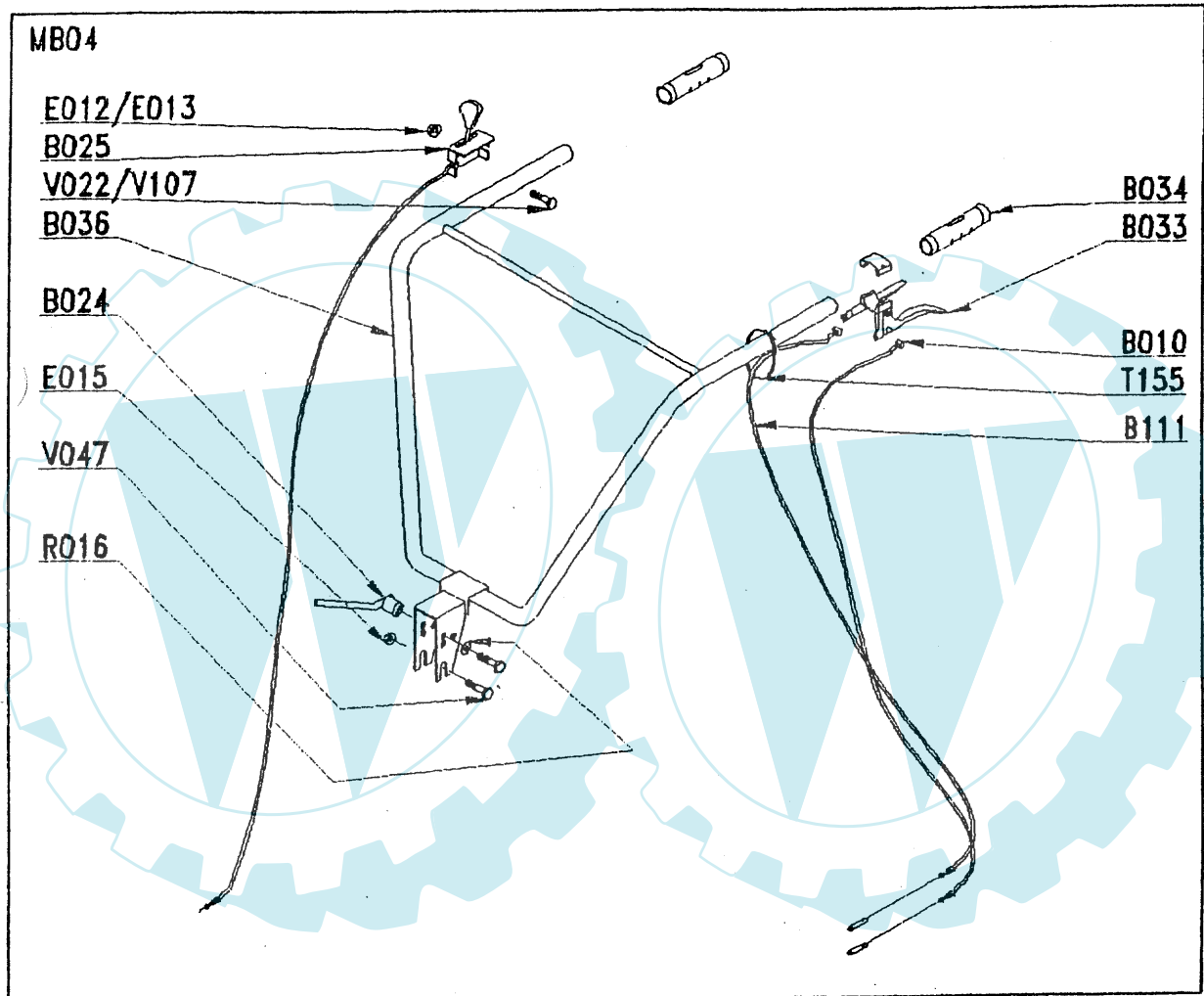

REPERES CODE ARTICLE

| | |
|------|------------|
| B000 | 00100339 |
| B001 | 92100046/N |
| B002 | 92005263 |
| B003 | 92005268/V |
| B004 | 92005265/J |
| B005 | 00010900 |
| B007 | 00010929 |
| B010 | 92100075 |
| B011 | 92000016 |
| B012 | 92005109/N |
| B014 | 92005323 |
| B015 | 92005141 |
| B016 | 92005235/V |
| B017 | 92005101/V |
| B018 | 92005142/N |
| B024 | 92100036 |
| B025 | 92100123 |
| B033 | 90100200 |
| B034 | 90100061 |
| B036 | 92005123/N |
| B041 | 92005148 |
| B042 | 90100056 |
| B043 | 90100082 |
| B044 | 92005149 |
| B045 | 92005147 |
| B046 | 92005205 |
| B047 | 92005228 |
| B048 | 92005169 |
| B049 | 90100191 |
| B050 | 90100027 |
| B051 | 90200040 |
| B052 | 92005167 |
| B053 | 92005168 |
| B054 | 92005274 |
| B055 | 92005153 |
| B079 | 92005113 |
| B090 | 92100180 |
| B091 | 92005273 |
| B096 | 92005311 |
| B101 | 92005206 |
| E005 | 90105509 |
| E006 | 90105502 |
| E013 | 90896083 |
| E014 | 90100044 |
| E015 | 90315001 |
| E016 | 90105511 |
| E019 | 90805504 |
| R006 | 90105058 |
| R008 | 90107007 |
| R015 | 90107000 |
| R016 | 90107003 |

REPERES CODE ARTICLE

| | |
|------|----------|
| T155 | 90100670 |
| V001 | 90803134 |
| V003 | 90892074 |
| V008 | 92100081 |
| V022 | 90105072 |
| V026 | 90105059 |
| V027 | 90105004 |
| V031 | 92005018 |
| V032 | 92005020 |
| V034 | 90800019 |
| V035 | 90892057 |
| V042 | 92005150 |
| V046 | 90105009 |
| V047 | 90105071 |
| V052 | 90105076 |
| V059 | 90105070 |
| V081 | 90105025 |
| X004 | 92100072 |
| X009 | 92000087 |
| X016 | 90195012 |
| X022 | 92100103 |